

NOTES:

1. DESIGN AIRCRAFT USED FOR THIS ANALYSIS IS A BEECH KING AIR B-100 WITH A TAIL HEIGHT OF 15'-6" AND WING SPAN OF 46'-0".
2. AIRPORT REFERENCE CODE = B-1
3. PART 77 PRIMARY SURFACE WIDTHS: RW 14-32 = 500'; RW 3-21 = 250'.
4. AIRCRAFT PARKING AREA INDICATED IS BASED ON TAXIWAY OBJECT FREE AREA CRITERIA FOR THE DESIGN AIRCRAFT ON THE SOUTH SIDE OF THE TAXIWAY, SUBJECT TO PRESCRIBED FAA MODIFICATION OF STANDARD REQUIREMENTS.

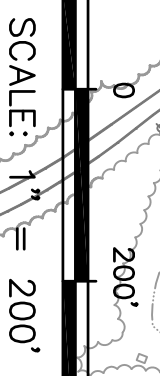
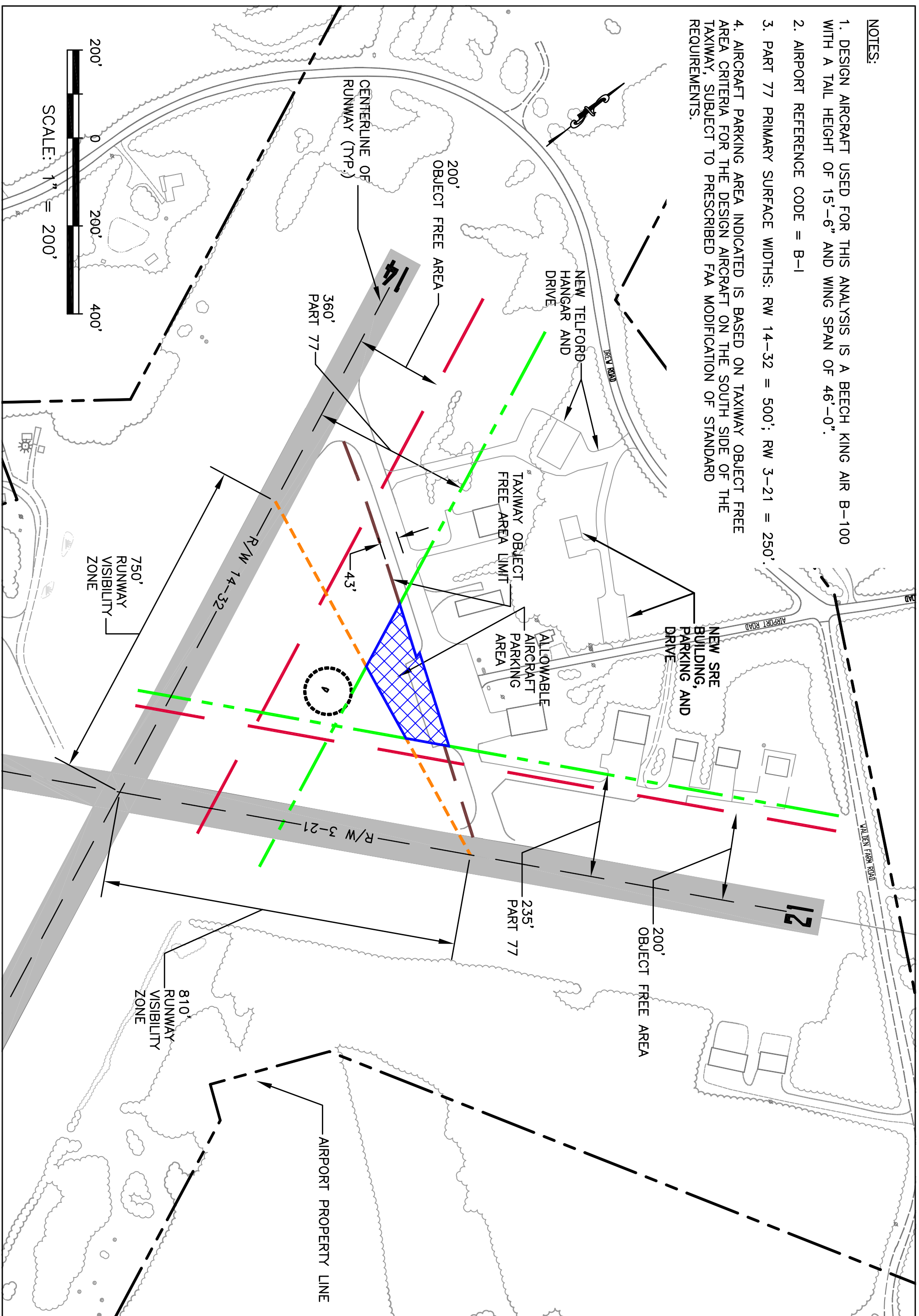

Project No.	8140058.01
Proj. Manager	WAG
Proj. Designer	SGM
Drawn By	SGM
Checked By	WAG
Scale	1"=200'
Approved	WAG
Date	JANUARY 2005

GREENVILLE MUNICIPAL AIRPORT
AIP. PROJECT NO. 3-23-0023-07

AIRCRAFT PARKING SETBACK LIMITS

GREENVILLE MAINE

Rev.	Description	By	Date

Dufresne-Henry
Presque Isle, Maine
Tel. (207) 764-6700 • Fax (207) 764-7007
www.dufresne-henry.com